

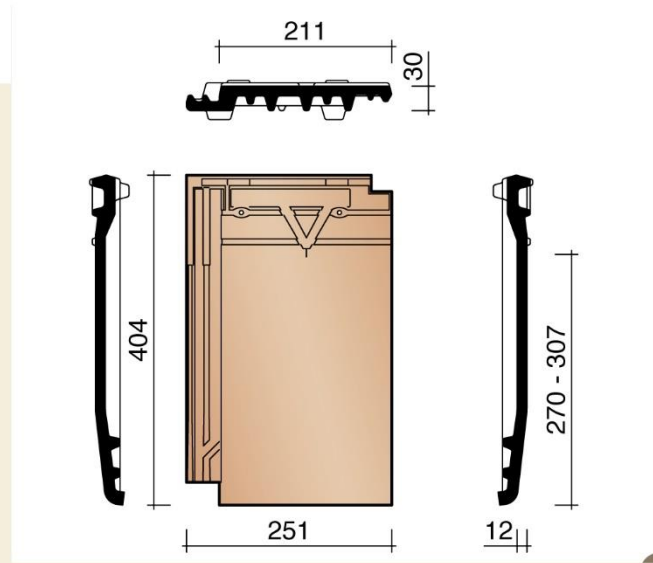

# KORAMIC

Kleidakpannen. Tuiles Terre Cuite.

## Datura

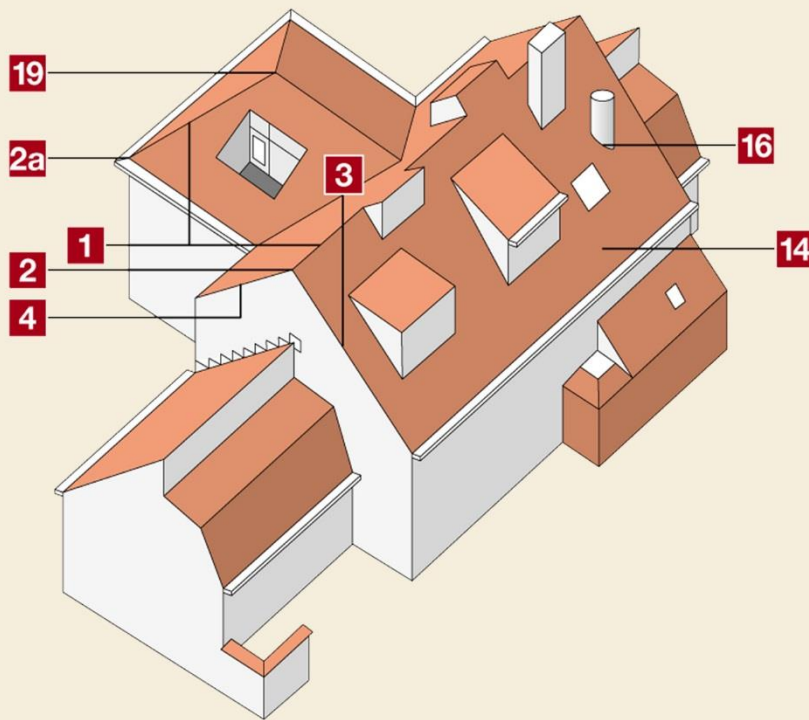

### TECHNICAL DATA



Data	Brand: Narvik
	Model: Datura
Minimum pitch	25°
Variable batten spacing	270 to 307 mm
Tiles/m <sup>2</sup>	± 15.4
Weight/tile	± 3.15 kg
Weight/m <sup>2</sup>	± 48.5 kg
Crushing strength	> 900 N (EN538)
Water impermeability	≤ 0.50 cm <sup>3</sup> /cm <sup>2</sup> .d (EN539-1)
Frost resistance	guarantee for 30 years
Batten size	50 x 25 mm (BS 1202)

### ROOF DETAILS

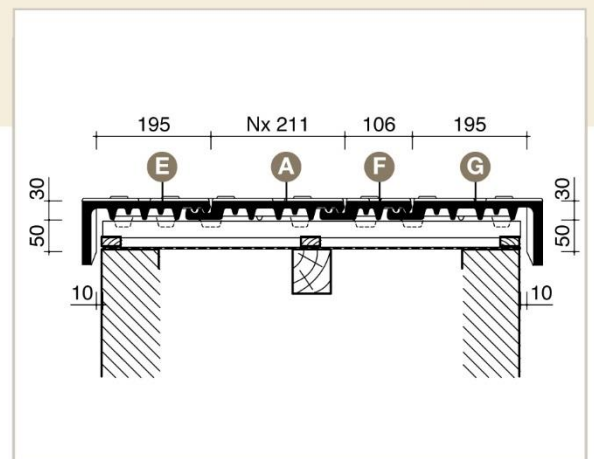
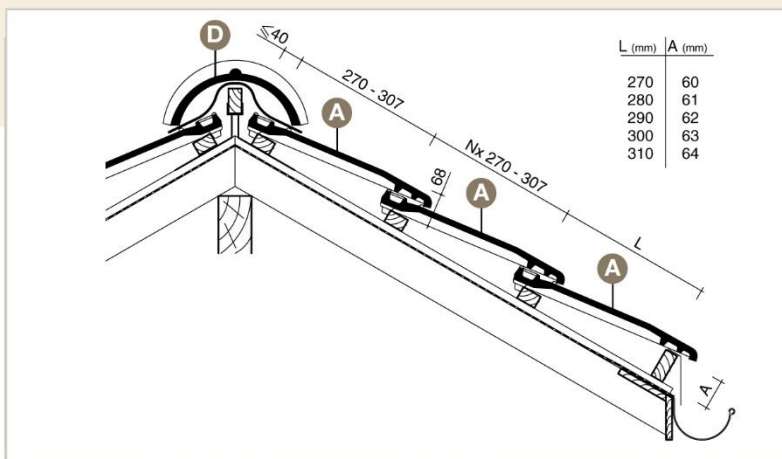
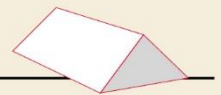

# RIDGES AND HIP TILES

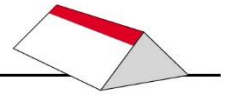

<p><b>Angular ridge (3/m)</b></p> <p>Ref. No. 2800</p> <p><b>D 1</b></p>	<p><b>Angular begin ridge</b></p> <p>Ref. No. 2810</p> <p><b>2</b></p>	<p><b>Angular end ridge</b></p> <p>Ref. No. 2820</p> <p><b>2</b></p>	<p><b>Angular begin hip</b></p> <p>Ref. No. 2860</p> <p><b>2a</b></p>
--	--	--	---

# VERGE & VARIOUS FITTINGS

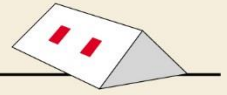

<p><b>Cloaked verge tile left hand (1.65/m)</b></p> <p>Ref. No. 7080</p> <p><b>E 3</b></p>	<p><b>Cloaked verge tile right hand (1.65/m)</b></p> <p>Ref. No. 7090</p> <p><b>G 4</b></p>	<p><b>1/2 cloaked verge tile left hand (1.65/m)</b></p> <p>Ref. No. 7020</p> <p><b>3</b></p>
<p><b>1/2 cloaked verge tile right hand (1.65/m)</b></p> <p>Ref. No. 7030</p> <p><b>4</b></p>	<p><b>Half tile (3.3/m)</b></p> <p>Ref. No. 8010</p> <p><b>F 14</b></p>	<p><b>Half tile without side interlocking (3.3/m)</b></p> <p>Ref. No. 8040</p> <p><b>3</b></p>
<p><b>Left hand verge/Double roll tile (3.2/m)</b></p> <p>Ref. No. 8050</p> <p><b>3</b></p>	<p><b>Steam-exhausting tile Ø 100 mm</b></p> <p>Ref. No. 8740</p> <p><b>16</b></p>	<p><b>Cap for steam-exhausting tile Ø 100 mm</b></p> <p>Ref. No. 8750</p> <p><b>16</b></p>
<p><b>Connector 3 directions</b></p> <p>Ref. No. 5340</p> <p><b>19</b></p>		